

Welcome to
London North

GLOBAL
SWITCH





YOUR FUTURE PROOFED DATA CENTRE

London North has evolved to meet the ever-changing demands of today's digital age.

Having recently undergone a transformation, our London North data centre offers a thriving ecosystem where leading organisations – both public and private – can connect seamlessly to telecommunication companies, ISPs, cloud providers and peers.

The enhancements include an additional technical space with the latest cooling technologies to maximise energy efficiency, a new reception area benefiting from enhanced security features, an improved Meet Me Room and a power upgrade.

As with all Global Switch data centres, London North delivers numerous connectivity options and a highly resilient environment with scalable technical space and power solutions. It also meets our best-in-class operational and environmental management processes and operates to Tier III plus standards.



A WORLD-CLASS
DATA CENTRE



OPERATIONAL
EXCELLENCE



NETWORK
DENSE



CLOUD
CONNECTIVITY



CARRIER
NEUTRAL



BESPOKE
SOLUTIONS

JOIN OUR GLOBAL NETWORK

We are a leading large-scale, carrier and cloud neutral, multi customer data centre owner and operator across Europe and Asia-Pacific.

Established in 1998, we offer a tailor-made service across our network of hyperscale carrier and cloud neutral data centres. All of our sites deliver secure and resilient solutions with scalable capacity, are strategically located in key international business and connectivity hubs, and operate to Tier III plus standards.

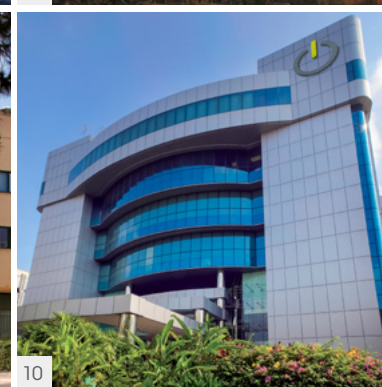
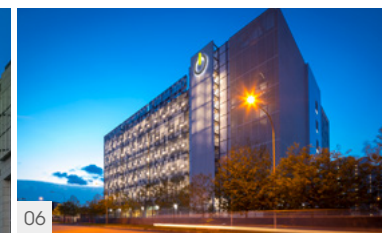
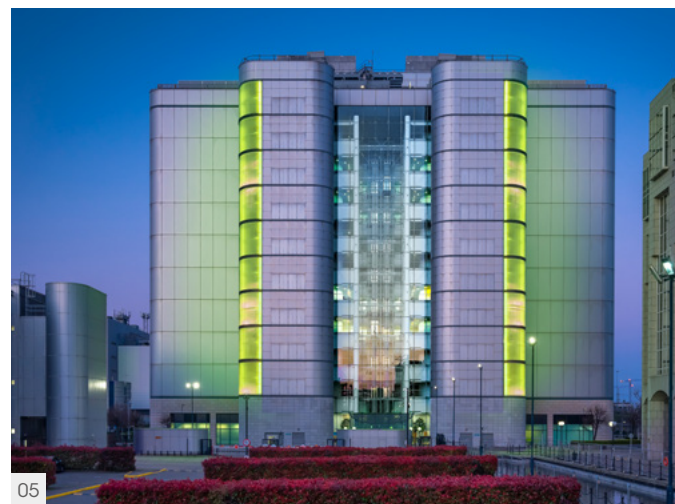

GLOBAL SWITCH AT A GLANCE

- A strong network of world-class data centres
- Low latency locations in Tier 1 markets close to business, communications and internet hubs
- Rich ecosystem with some of the world's leading connectivity and cloud service providers alongside global system integrators and financial services solution specialists
- Economies of scale provide substantial energy efficiencies which result in reduced total occupancy costs
- Unrivalled power with multiple layers of redundancy
- State of the art security and monitoring systems in place 24x7x365
- Industry-leading reliability with comprehensive Critical Environments Programme
- Investment grade credit ratings received from Fitch, Moody's and Standard & Poor's
- Strong management team with significant industry experience

- 01 FRANKFURT CAMPUS
- 02 HONG KONG
- 03 SYDNEY EAST*
- 04 SYDNEY WEST*
- 05 LONDON EAST
- 06 SINGAPORE WOODLANDS
- 07 PARIS CAMPUS
- 08 AMSTERDAM CAMPUS
- 09 MADRID
- 10 SINGAPORE TAI SENG

* Consolidated Group entity

LONDON; AT THE CENTRE OF THE CONNECTED WORLD

London North is in the heart of London Docklands, one of the most network dense locations in the world.

Global Switch owns and operates data centres in many of the world's strategic communication and financial hubs and London North is no exception. London is one of the top financial centres in the world and hub to the majority of the country's leading companies and financial institutions as well as being the regional headquarters for numerous multinational corporations.

With the largest internet capacity in Europe and currently a first choice location for a variety of low latency dependent organisations, London Docklands is one of the most connectivity rich areas in the world.

This has therefore attracted a huge, diverse range of network providers, giving organisations access to a broad choice of connectivity partners and services.

London North is adjacent to Global Switch London East, the largest purpose built data centre in Europe. Together the two data centres form Global Switch's London data centre campus.

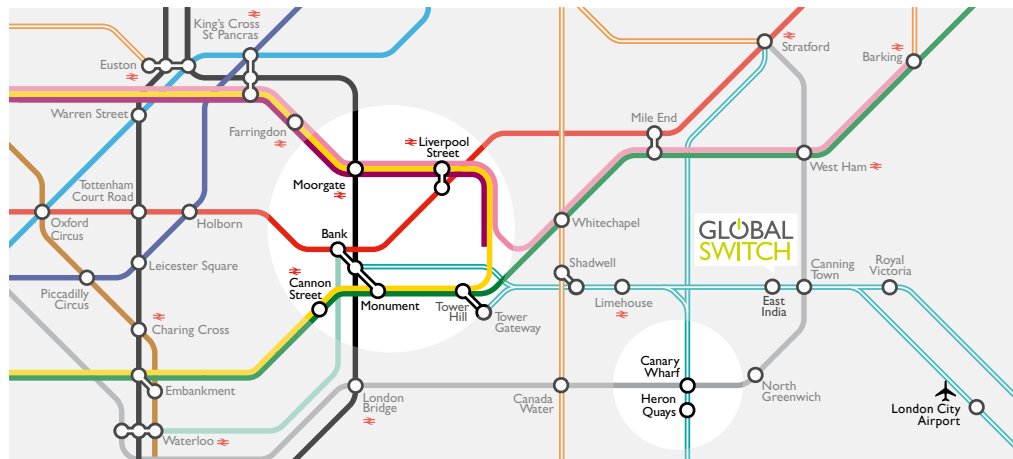

— DLR
— Central
— Northern
— Jubilee
— Metropolitan

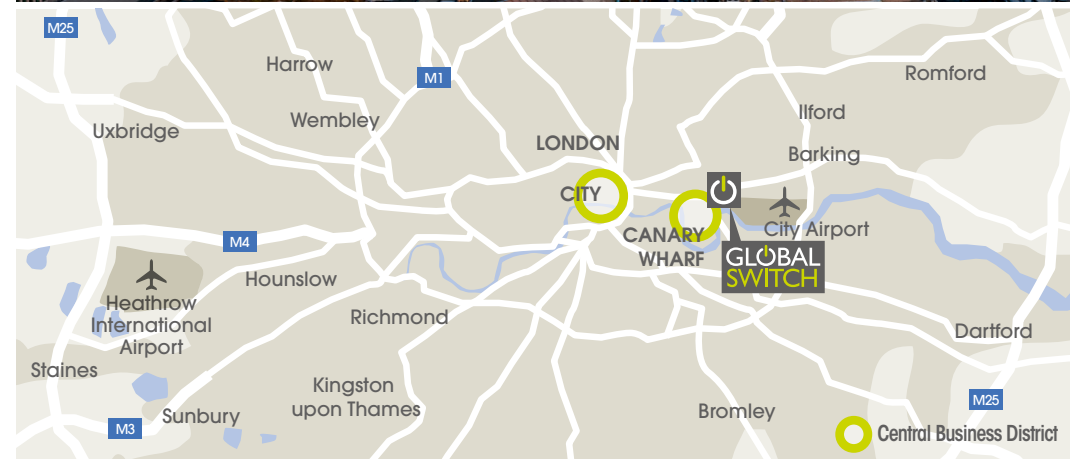

KEY LOCATION FEATURES

- Located on the edge of the financial district and close to the City of London
- Adjacent to the main international fibre routes
- Low latency
- Serviced by multiple telecommunication exchanges and a dense carrier presence providing exceptional connectivity
- Well served by the major transport networks, with a local railway station within a 5 minute walk, and London City Airport 10 minutes away by car

A NEXT GENERATION DATA CENTRE

Always evolving to meet the needs of our customers, we have enhanced both the space and services at London North.

The transformation has provided a new reception area encompassing enhanced security, a power upgrade for high density requirements and an improved Meet Me Room.

Our new technical space (Area 3) features dedicated cooling systems, further improving our customers' energy savings. This area leads the way in environmentally sustainable design and an annualised PUE of less than 1.2 by using the latest technologies, including adiabatic free cooling chillers.

These changes strengthen an operational environment that enables our customers to reduce their carbon footprint and drive greater efficiency from their operations, reducing total cost of occupancy and minimising operational risk.

Global Switch data centres, including London North, operate to Tier III plus standards. As a company we are certified to ISO 9001, 14001, 27001, 45001 and 50001.



POWER
UPGRADE



ENHANCED
SECURITY



SUSTAINABLE
SOLUTIONS





State of the art technical space with a scalable approach: design can be tailored to suit customer needs

KEY FEATURES

- 23,439 sq m of space with 13MVA utility power supply capacity
- High density as standard with flexibility to meet a range of requirements
- Carrier neutral with access to multiple Tier 1 and Tier 2 international carrier networks
- PUE of less than 1.2 for Area 3
- Flexible solutions from single rack deployments through to multi-megawatt bespoke solutions
- Dedicated security infrastructure systems, with HD video surveillance system and biometric entry controls
- Low risk operational environment

London North level one

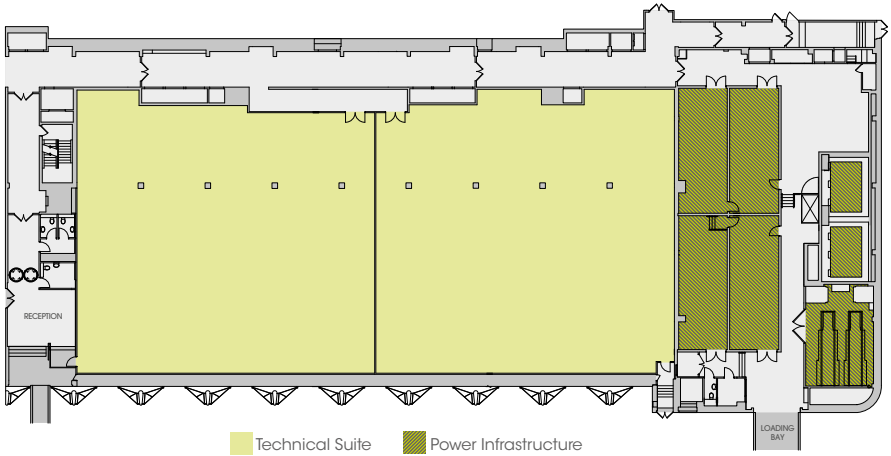

OUTSTANDING CONNECTIVITY

Our carrier neutral stance delivers a great choice of peering exchanges and carrier networks, resulting in direct connections and lower latency.

Access to multiple ISPs and Tier 1 and Tier 2 carriers is essential to business continuity and increasing network reach, so Global Switch data centres are located in key connectivity hubs across Europe and Asia-Pacific, in close proximity to international fibre routes.

Due to its unique location, its scale and impressive track record, London North enjoys one of the most network dense environments in Europe.

Adjacent to the main international fibre routes and with direct access to two major subsea cables, the data centre also benefits from the rich connectivity of London East.

The ability to establish direct connections to a vast portfolio of service providers also gives you the flexibility to diversify your network and connect your data centres as your business needs evolve.

KEY FEATURES

- London North is adjacent to the main international fibre routes
- Direct access to two major subsea cables (Atlantic Crossing 1 and the West African Cable System)
- Network dense with all the major Tier 1 and Tier 2 carriers present as well as multiple dark fibre providers and ISPs
- Access to multiple cloud services through leading public, private and hybrid cloud solution providers
- Two dedicated Meet Me Rooms providing diversity and connection options
- Structured cabling system linking London North and London East
- Location allows low latency connectivity to the financial district and city centre



FLEXIBLE SCALABLE SPACE

By understanding our customers' requirements we are able to apply our expertise, flexibility and scalability to meet any challenge.

Our focus is on creating a high quality data centre environment bespoke to your needs. Through the experience we have gained over many years we have developed a wide variety of solutions including some of the most advanced high density solutions of their kind.



CUTTING-EDGE OPERATIONS

Our international teams share their knowledge to keep Global Switch at the forefront of data centre management.

Global Switch has built a reputation for creating data centres that set new standards in scale, connectivity and resilience. Being able to offer robust and scalable solutions in terms of space, power and cooling has been the driver for many of the leading businesses that choose Global Switch as their European and Asia-Pacific data centre provider.

We operate a centrally-run, industry-leading Critical Environments Programme across all of our global data centres, with dedicated teams in each location. These teams drive a common set of best practice standards, systems, processes and procedures.

Our uncompromising approach to infrastructure, gives you reassurance 24x7x365.



OUR LONDON NORTH DATA CENTRE SOLUTIONS INCLUDE



PRIVATE SUITES

These self-contained areas, which can include 24x7x365 network operating centre facilities, are designed and built to customers' bespoke specifications and layout requirements.



CAGES

Our cages are secure, flexible, private areas offering the benefit of large-scale resilience for medium-sized IT space and power requirements. Customers can specify the design and layout they need.



MEET ME ROOMS

Our diversely routed Meet Me Rooms offer our telecoms, ISP and network providers a highly secure area to establish Points of Presence to connect to any customer throughout the data centre.



ADDITIONAL SERVICES

Our range of additional services extends from tailored private offices and meeting rooms through to remote hands, technical cleaning, cable management and secure storage.



TECHNICAL SPECIFICATION

Main Structural Features

- Steel frame with concrete floors, metal faced cladding and glazing
- 5m slab to slab height
- Raised floor height of 600mm (Areas 1 and 2), 800mm (Area 3)
- Minimum from raised floor: 3.8m clear height to underside of deepest beam
- Floor loading of 5kN/m² (Areas 1 and 2), 12kN/m² (Area 3)
- 2 goods lifts (2.5 tonnes), 2 passenger lifts

Power

- 11kV utility supply with N+1 redundancy
- Utility power supply capacity of 13MVA (current)
- Technical (IT) power supplied by on-site static N+1 UPS in Area 1 and by Diesel Rotary UPS with N+1 redundancy in Areas 2 and 3
- Mechanical systems backed up by standby generator system for Area 1 with N+1 redundancy
- Fully diverse power distribution to technical areas
- On-site fuel storage to support 48 hours at full capacity with 24x7x365 fuel delivery
- Offering 2,000 W/m² as standard with higher power density solutions fully supported
- Annualised PUE of less than 1.2 in Area 3

Cooling

- 15.8MW of installed cooling provision
- Minimum N+1 resilience on all systems
- CRAC units control temperature and humidity in technical space within the recommended range of ASHRAE TC9.9
- Diverse distribution pipework throughout
- Chilled water cooling system
- In rack cooling capability if required

Security

- Operations Centre manned 24x7x365
- Security guard patrols 24x7x365
- Continuous CCTV surveillance of external and internal areas
- CCTV records kept for 31 days
- Comprehensive intruder detection and alarms to all areas
- Perimeter Intrusion Detection System (PIDs)
- Strict access control procedures to ISO 27001
- Access control using proximity card readers
- Physical access via mantrap
- Secure managed delivery and loading area available 24x7x365

Connectivity

- Carrier Neutral
- Network dense with access to multiple global and regional carriers and Internet service providers offering Dark Fibre, Wavelength, Ethernet, MPLS, VPLS, IP Transit, Peering, CDN, Storage, Virtualised Services (SDN), Voice and Mobile Services
- Access to multiple cloud services through leading public, private and hybrid cloud solution providers
- 2 dedicated Meet Me Rooms
- 2 diverse building entry points
- Diverse cable routes and pathways
- Campus fibre system interconnecting London North and London East
- Roof space availability for satellite and antennae equipment
- Multiple LINX Fibre/Capacity Partners and remote peering service providers

Fire Detection and Suppression

- Analogue addressable fire detection system in all areas
- Aspirated early warning smoke detection system (monitored 24x7x365)
- Argonite and FM200 gas suppression systems in technical areas

Critical Environments Management

- Experienced 24x7x365 facilities management team
- Environment (thermal conditions) monitored 24x7x365
- All Building Management Systems (BMS) monitored 24x7x365
- Comprehensive energy metering system
- Internationally recognised critical environments programme

Other Services

- Cross connects
- Customer reports
- Deliveries and storage
- Design and build
- Fit out
- On-site facilities
- Remote hands
- Technical cleaning and waste disposal

Certifications

- ISO 9001, 14001, 27001, 45001, 50001.
- Membership of the United Kingdom Climate Change Agreement (CCA)

Leading the way for the data centre industry, Global Switch is the only choice for resilience, innovation, scalability and agility.

We look forward to welcoming you to our world class London North Data Centre and becoming your local and worldwide data centre partner.

Global Switch London North

East India Dock House, 240 East India Dock Road, London E14 9YY
+44 20 7473 9000
saleslondon@globalswitch.com

The information provided in this brochure is intended to be used for illustrative purposes only and does not constitute part of any offer or offer to contract. This brochure is given with no knowledge of your needs or requirements, and any information herein contained is not warranted as accurate or complete. Global Switch Limited and its consolidated entities accept no liability arising due to your reliance upon the contents of this brochure. © Global Switch 2022



CONTACTS

Corporate Office

+44 20 8054 9000

info@globalswitch.com

DATA CENTRES

EUROPE

Global Switch Amsterdam

+31 20 6666 300

salesamsterdam@globalswitch.com

Global Switch Frankfurt

+49 69 74 22 70

salesfrankfurt@globalswitch.com

Global Switch London

+44 20 7473 9000

saleslondon@globalswitch.com

Global Switch Madrid

+34 91 312 06 00

salesmadrid@globalswitch.com

Global Switch Paris

+33 1 55 90 04 60

salesparis@globalswitch.com

ASIA-PACIFIC

Global Switch Hong Kong

+852 3955 1000

saleshongkong@globalswitch.com

Global Switch Singapore

+65 6958 1800

salessingapore@globalswitch.com

Global Switch Sydney*

+61 2 9566 7000

salessydney@globalswitch.com

** Consolidated Group entity*